

# HyNet North West

## Crown Land Plans

### HyNet Carbon Dioxide Pipeline DCO

Planning Act 2008

The Infrastructure Planning (Applications: Prescribed Forms and Procedure) Regulations 2009 –  
Regulations 5(2)(n)

Document Reference Number D.2.3

**Applicant:** Liverpool Bay CCS Limited

**PINS Reference:** EN070007

English Version

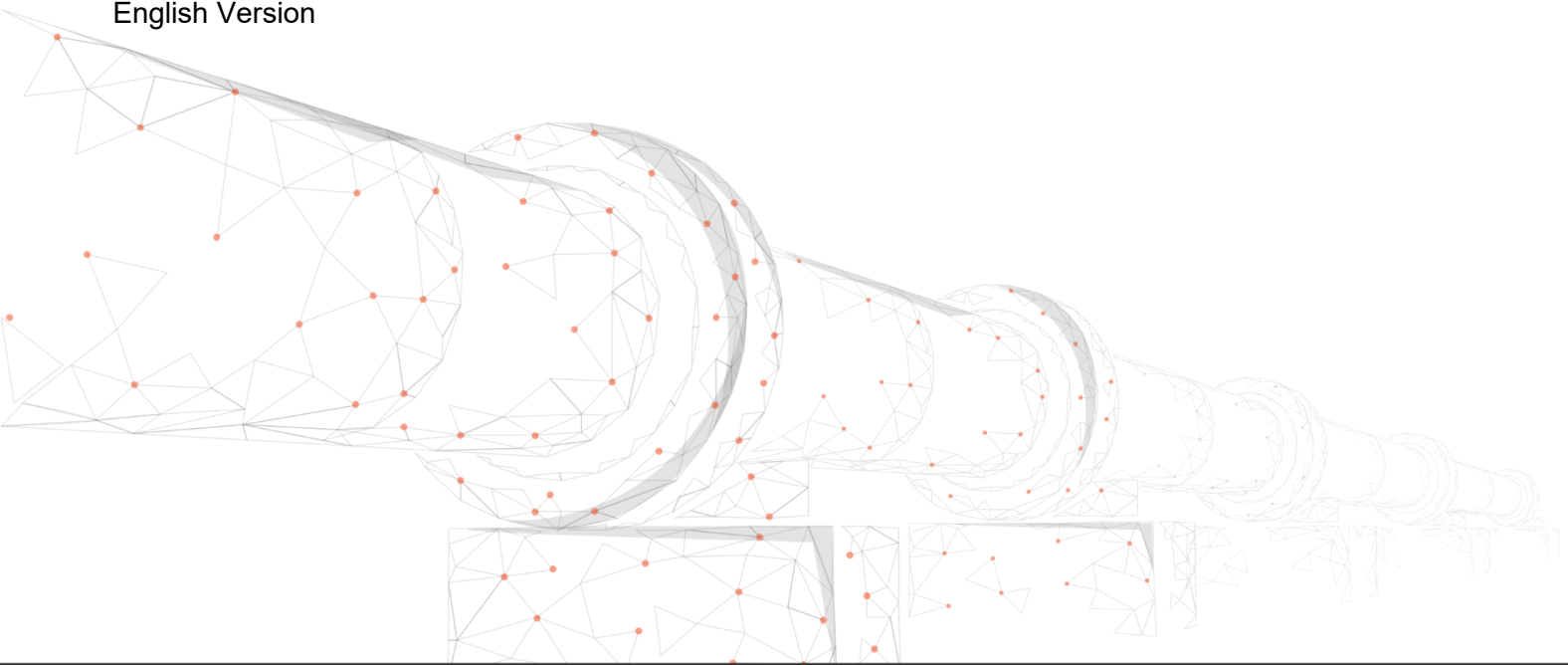

REVISION: D

DATE: May 2023

DOCUMENT OWNER: WSP UK Limited

PUBLIC

## QUALITY CONTROL

---

<b>Document Reference</b>		<b>D.2.3</b>		
<b>Document Owner</b>		<b>WSP</b>		
<b>Revision</b>	<b>Date</b>	<b>Comments</b>	<b>Author</b>	<b>Approver</b>
<b>A</b>	September 2022	Submitted with DCO application	PT	VB
<b>B</b>	March 2023	Update from S51 advice for Rev B	PT	VB
<b>C</b>	March 2023	Updated for ES Addendum Design Change Request 1	PT	VB
<b>D</b>	May 2023	Updated for Deadline 3	PT	VB

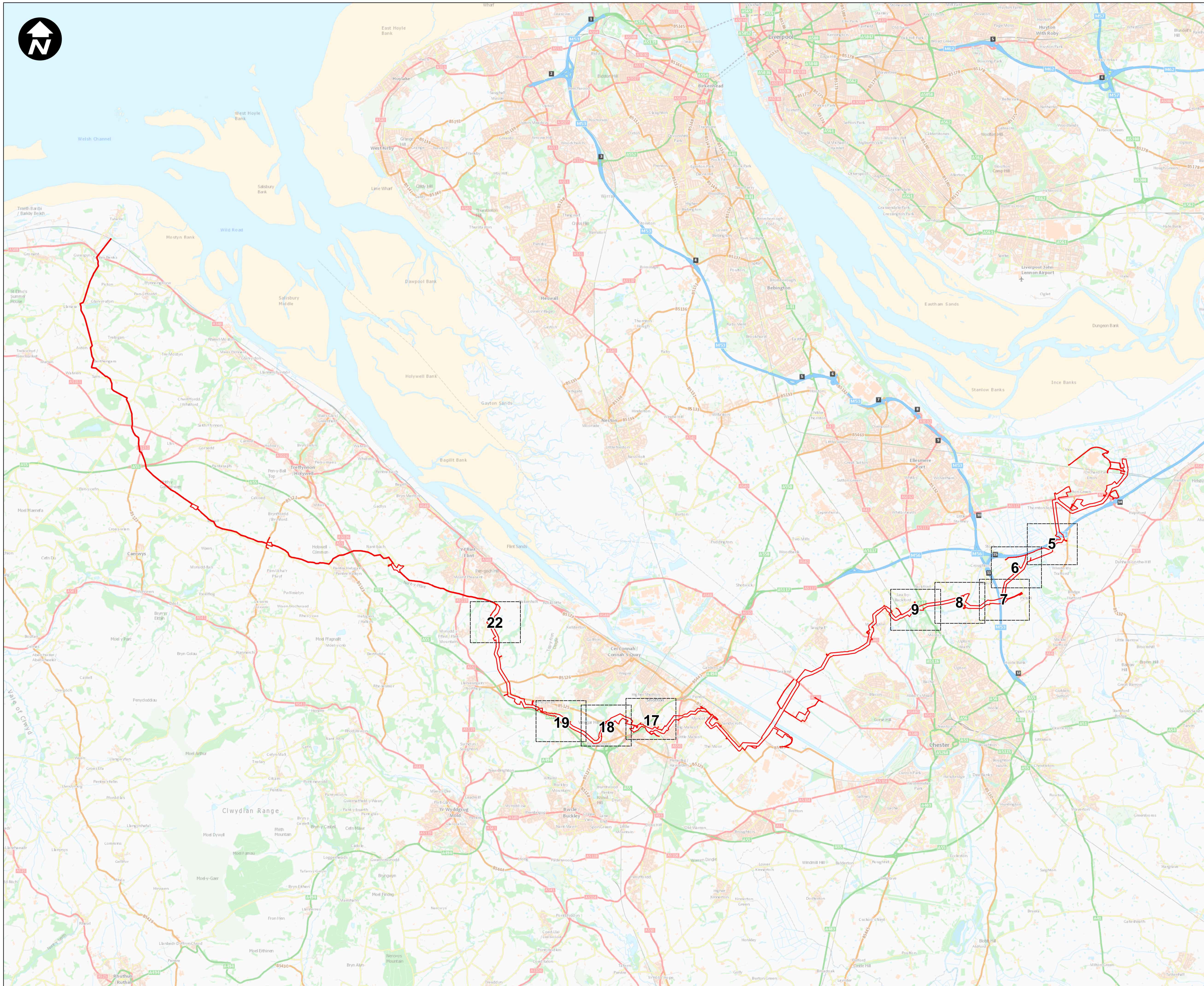

Service Layer Credits: Contains OS data © Crown Copyright and database right 2020 **1:750,000**

**Key:**  
 Order Limits

1. All dimensions are in metres unless stated otherwise.
2. These Land Plans should be read in conjunction with other plans and documents in the Development Consent Order application in particular the Book of Reference.
3. All easements, servitudes and private rights in land are proposed to be extinguished on land shown coloured pink on these land plans. All easements, servitudes and private rights in land are proposed to be extinguished, so far as their continued exercise would be inconsistent with the exercise of the rights or restrictions proposed to be acquired by the undertaker on land shown coloured blue on these land plans. All easements, servitudes and private rights are proposed to be suspended while the undertaker is in temporary possession of the land shown coloured green on these land plans.
4. The number labels relate to plot numbers. Please refer to the Book of Reference for more information about these plots, including the approximate area of each plot (in square metres). Plot numbers include a reference to the relevant sheet of the Land Plans. In this numbering convention, a plot number comprises the sheet number followed by the actual plot number, e.g. Plot 01-24, where '01' is the sheet number (sheet 1) and '24' is the plot number (24 on sheet 1).

D	NC	PT	VB	18/05/2023
C	RH	PT	VB	28/02/2023
B	NC	RB	VB	13/01/2023
A	PM	JH	VB	27/09/2022
<b>REVISION</b>	<b>DRAWN</b>	<b>CHECKED</b>	<b>APPROVED</b>	<b>DATE</b>

**SCALE: 1:60,000**  
 0                      2,500                      5,000  
 Metres

Mapping reproduced by permission of Ordnance Survey on behalf of HMSO  
 Contains OS data © Crown Copyright and database right 2022

# HyNet North West

## PROJECT TITLE HyNet Carbon Dioxide Pipeline DCO

**DRAWING TITLE**  
 CROWN LAND PLANS REGULATION (5)(2)(n)  
 APPLICATION DOCUMENT REFERENCE D.2.3  
 KEY PLAN

<b>DRAWING STATUS</b>			
<b>DEADLINE 3</b>			
<b>DRAWN</b>	<b>CHECKED</b>	<b>APPROVED</b>	<b>AUTHORISED</b>
NC	PT	VB	AV
<b>SCALE @ A1 SIZE</b>		<b>DATE</b>	<b>REVISION</b>
1:60,000		18/05/2023	D



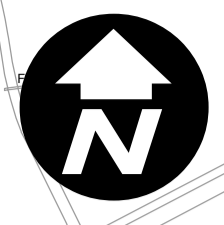

**DRAWING NUMBER**  
 EN070007-D.2.3-CLP-Key Plan



Service Layer Credits: Contains OS data © Crown Copyright and database right 2020

1:350,000

**Key:**

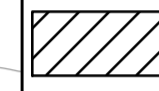
-  Order Limits
-  Permanent acquisition of land
-  Permanent acquisition of subsurface
-  Temporary possession of land
-  Crown Land

1. All dimensions are in metres unless stated otherwise.
2. These Land Plans should be read in conjunction with other plans and documents in the Development Consent Order application in particular the Book of Reference.
3. All easements, servitudes and private rights in land are proposed to be extinguished on land shown coloured pink on these land plans. All easements, servitudes and private rights in land are proposed to be extinguished, so far as their continued exercise would be inconsistent with the exercise of the rights or restrictions proposed to be acquired by the undertaker on land shown coloured blue on these land plans. All easements, servitudes and private rights are proposed to be suspended while the undertaker is in temporary possession of the land shown coloured green on these land plans.
4. The number labels relate to plot numbers. Please refer to the Book of Reference for more information about these plots, including the approximate area of each plot (in square metres). Plot numbers include a reference to the relevant sheet of the Land Plans. In this numbering convention, a plot number comprises the sheet number followed by the actual plot number. e.g. Plot 01-24, where '01' is the sheet number (sheet 1) and '24' is the plot number (24 on sheet 1).

D	NC	PT	VB	18/05/2023
C	RH	PT	VB	28/02/2023
B	NC	RB	VB	13/01/2023
A	PM	JH	VB	27/09/2022
REVISION	DRAWN	CHECKED	APPROVED	DATE

**SCALE: 1:2,500**



0 50 100 200 Metres

Mapping reproduced by permission of Ordnance Survey on behalf of HMSO  
 Contains OS data © Crown Copyright and database right 2022

# HyNet North West

**PROJECT TITLE**  
 HyNet Carbon Dioxide Pipeline DCO

**DRAWING TITLE**  
 CROWN LAND PLANS REGULATION (5)(2)(n) APPLICATION DOCUMENT REFERENCE D.2.3 SHEET 5

**DRAWING STATUS**  
 DEADLINE 3

<b>DRAWN</b>	<b>CHECKED</b>	<b>APPROVED</b>	<b>AUTHORISED</b>
NC	PT	VB	AV
<b>SCALE @ A1 SIZE</b>		<b>DATE</b>	<b>REVISION</b>
1:2,500		18/05/2023	D

**DRAWING NUMBER**  
 EN070007-D.2.3-CLP-Sheet 5

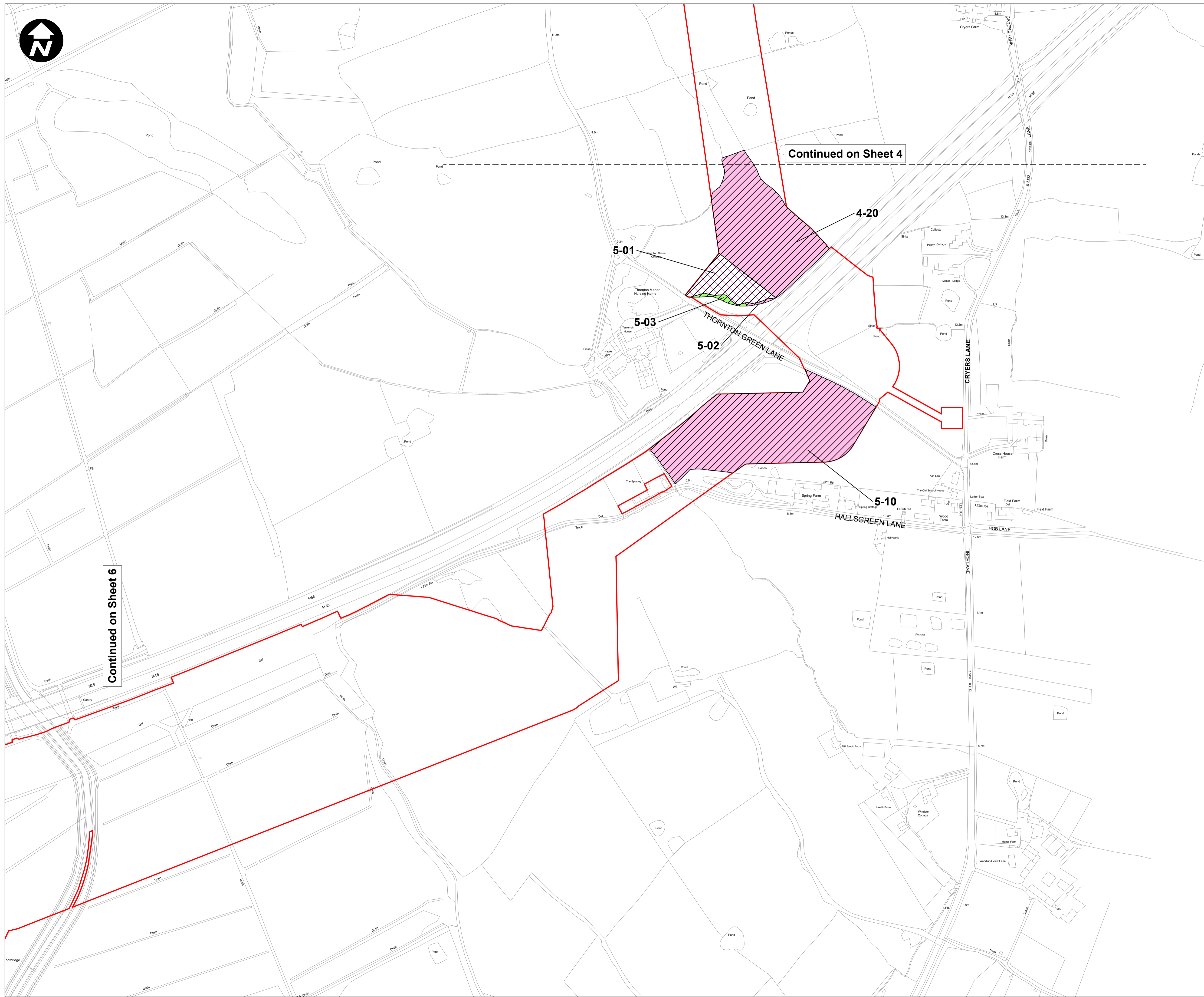

Continued on Sheet 4

Continued on Sheet 6

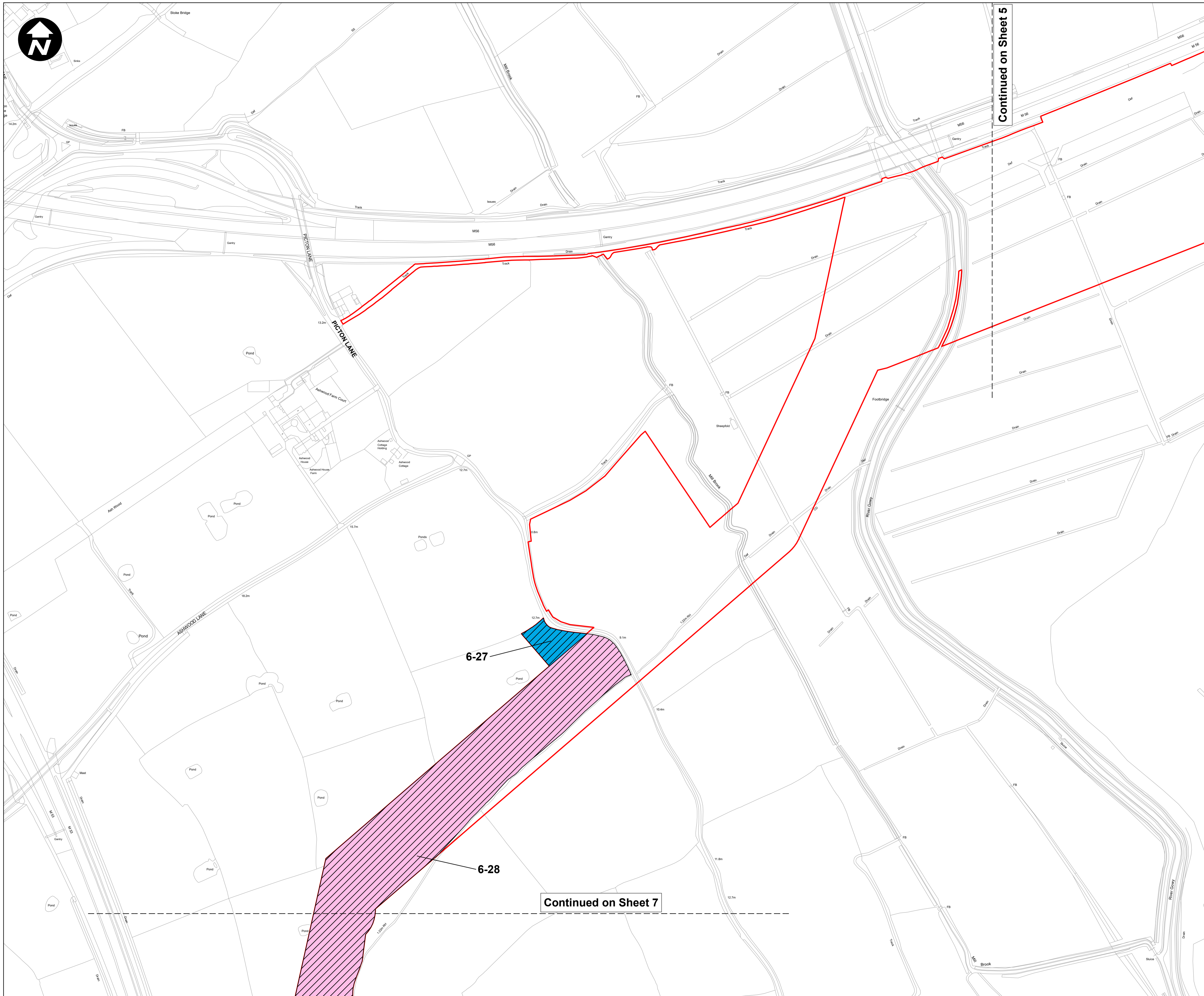

Continued on Sheet 5

Continued on Sheet 7

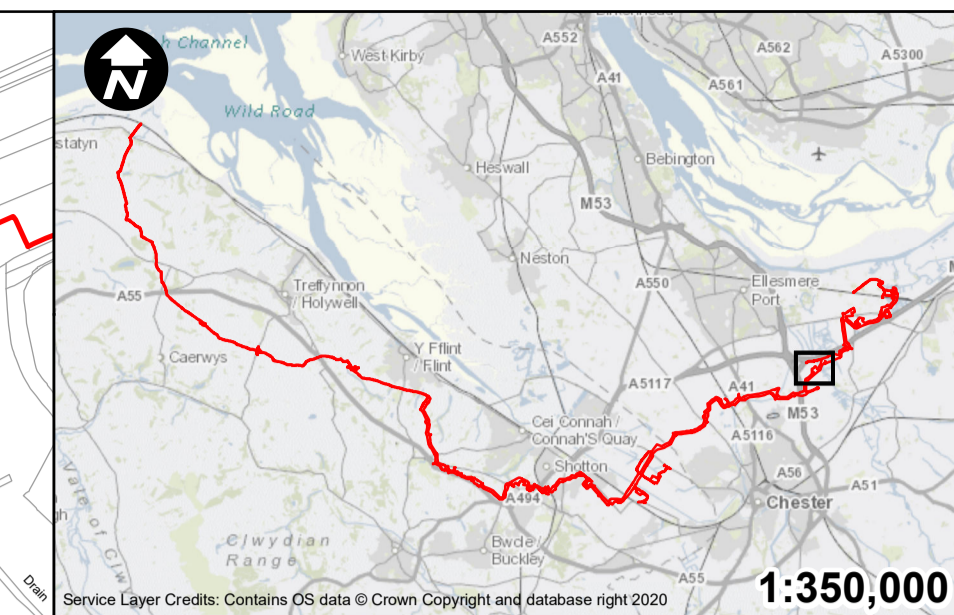

**Key:**

<span style="border: 1px solid red; display: inline-block; width: 15px; height: 10px;"></span>	Order Limits
<span style="background-color: pink; display: inline-block; width: 15px; height: 10px;"></span>	Permanent acquisition of subsurface
<span style="background-color: blue; display: inline-block; width: 15px; height: 10px;"></span>	Permanent acquisition of rights
<span style="background: repeating-linear-gradient(45deg, transparent, transparent 2px, black 2px, black 4px); display: inline-block; width: 15px; height: 10px;"></span>	Crown Land

- All dimensions are in metres unless stated otherwise.
- These Land Plans should be read in conjunction with other plans and documents in the Development Consent Order application in particular the Book of Reference.
- All easements, servitudes and private rights in land are proposed to be extinguished on land shown coloured pink on these land plans. All easements, servitudes and private rights in land are proposed to be extinguished, so far as their continued exercise would be inconsistent with the exercise of the rights or restrictions proposed to be acquired by the undertaker on land shown coloured blue on these land plans. All easements, servitudes and private rights are proposed to be suspended while the undertaker is in temporary possession of the land shown coloured green on these land plans.
- The number labels relate to plot numbers. Please refer to the Book of Reference for more information about these plots, including the approximate area of each plot (in square metres). Plot numbers include a reference to the relevant sheet of the Land Plans. In this numbering convention, a plot number comprises the sheet number followed by the actual plot number. e.g. Plot 01-24, where '01' is the sheet number (sheet 1) and '24' is the plot number (24 on sheet 1).

D	NC	PT	VB	18/05/2023
C	RH	PT	VB	28/02/2023
B	NC	RB	VB	13/01/2023
A	PM	JH	VB	27/09/2022
REVISION	DRAWN	CHECKED	APPROVED	DATE

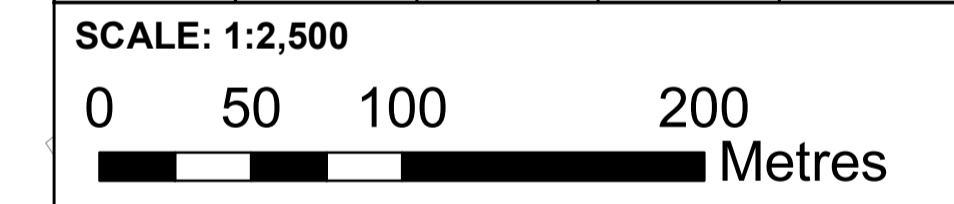

Mapping reproduced by permission of Ordnance Survey on behalf of HMSO  
 Contains OS data © Crown Copyright and database right 2022



**PROJECT TITLE**  
 HyNet Carbon Dioxide Pipeline DCO

**DRAWING TITLE**  
 CROWN LAND PLANS REGULATION (5)(2)(n) APPLICATION DOCUMENT REFERENCE D.2.3 SHEET 6

<b>DRAWING STATUS</b>			
DEADLINE 3			
<b>DRAWN</b>	<b>CHECKED</b>	<b>APPROVED</b>	<b>AUTHORISED</b>
NC	PT	VB	AV
<b>SCALE @ A1 SIZE</b>		<b>DATE</b>	<b>REVISION</b>
1:2,500		18/05/2023	D
<b>DRAWING NUMBER</b>			
EN070007-D.2.3-CLP-Sheet 6			

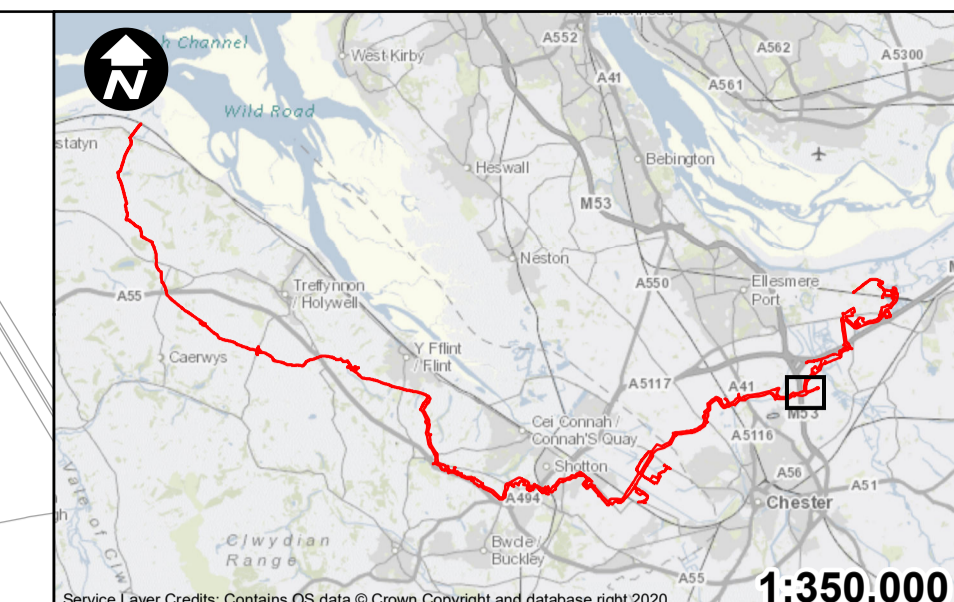
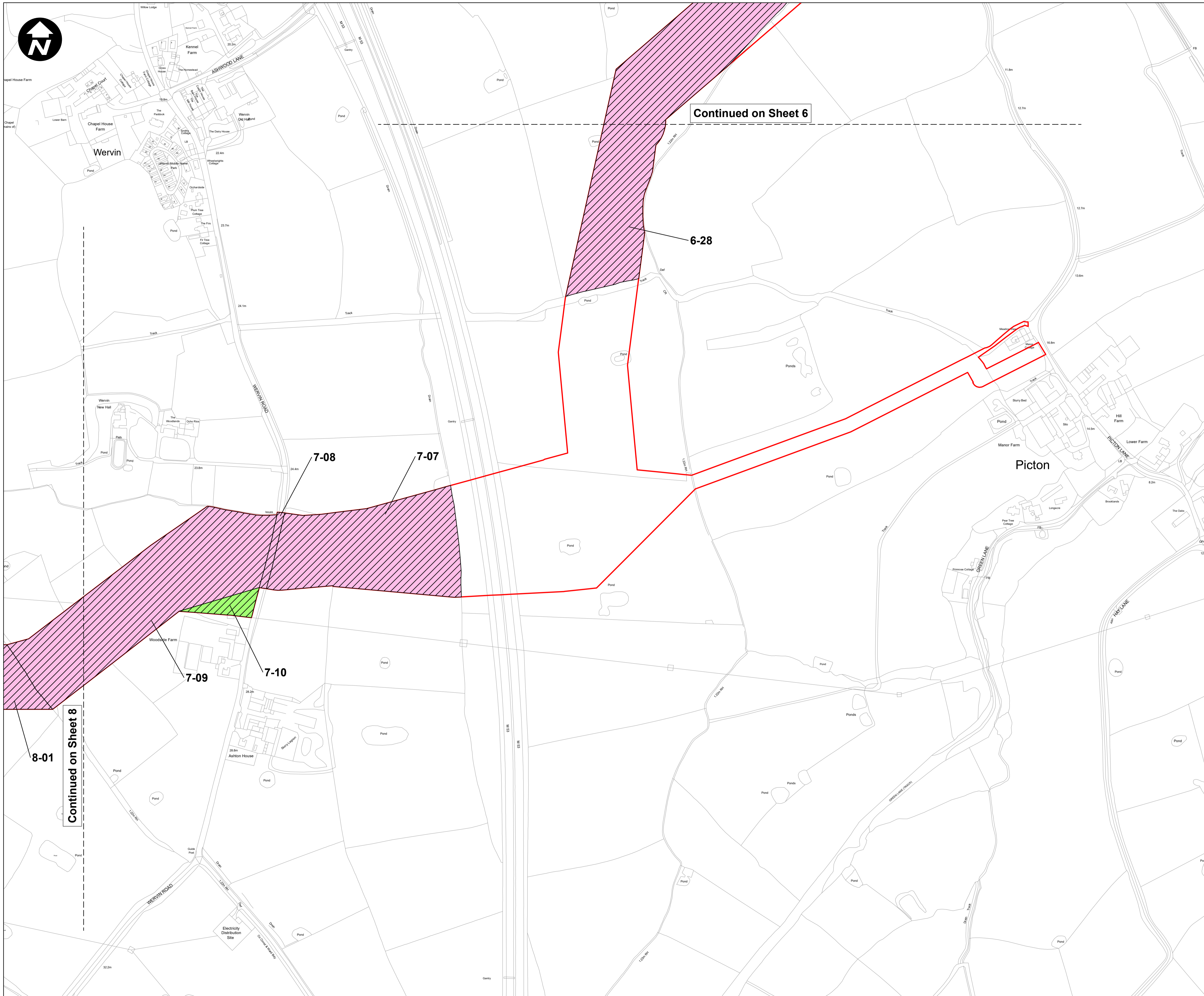

- Key:**
- Order Limits
  - Permanent acquisition of subsurface
  - Temporary possession of land
  - Crown Land

1. All dimensions are in metres unless stated otherwise.
2. These Land Plans should be read in conjunction with other plans and documents in the Development Consent Order application in particular the Book of Reference.
3. All easements, servitudes and private rights in land are proposed to be extinguished on land shown coloured pink on these land plans. All easements, servitudes and private rights in land are proposed to be extinguished, so far as their continued exercise would be inconsistent with the exercise of the rights or restrictions proposed to be acquired by the undertaker on land shown coloured blue on these land plans. All easements, servitudes and private rights are proposed to be suspended while the undertaker is in temporary possession of the land shown coloured green on these land plans.
4. The number labels relate to plot numbers. Please refer to the Book of Reference for more information about these plots, including the approximate area of each plot (in square metres). Plot numbers include a reference to the relevant sheet of the Land Plans. In this numbering convention, a plot number comprises the sheet number followed by the actual plot number. e.g. Plot 01-24, where '01' is the sheet number (sheet 1) and '24' is the plot number (24 on sheet 1).

D	NC	PT	VB	18/05/2023
C	RH	PT	VB	28/02/2023
B	NC	RB	VB	13/01/2023
A	PM	JH	VB	27/09/2022
REVISION	DRAWN	CHECKED	APPROVED	DATE

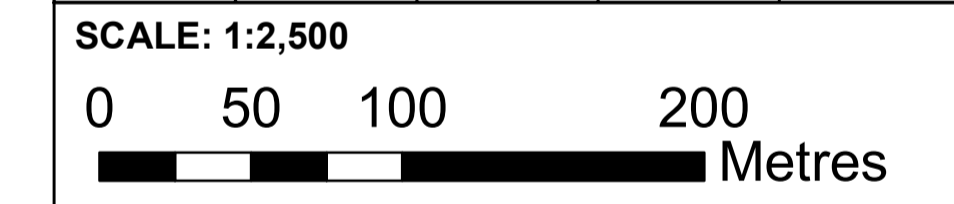

Mapping reproduced by permission of Ordnance Survey on behalf of HMSO  
 Contains OS data © Crown Copyright and database right 2022

# HyNet North West

**PROJECT TITLE**  
**HyNet Carbon Dioxide Pipeline DCO**

**DRAWING TITLE**  
 CROWN LAND PLANS REGULATION (5)(2)(n)  
 APPLICATION DOCUMENT REFERENCE D.2.3  
 SHEET 7

<b>DRAWING STATUS</b>			
<b>DEADLINE 3</b>			
<b>DRAWN</b>	<b>CHECKED</b>	<b>APPROVED</b>	<b>AUTHORISED</b>
NC	PT	VB	AV
<b>SCALE @ A1 SIZE</b>		<b>DATE</b>	<b>REVISION</b>
1:2,500		18/05/2023	D
<b>DRAWING NUMBER</b>			
EN070007-D.2.3-CLP-Sheet 7			

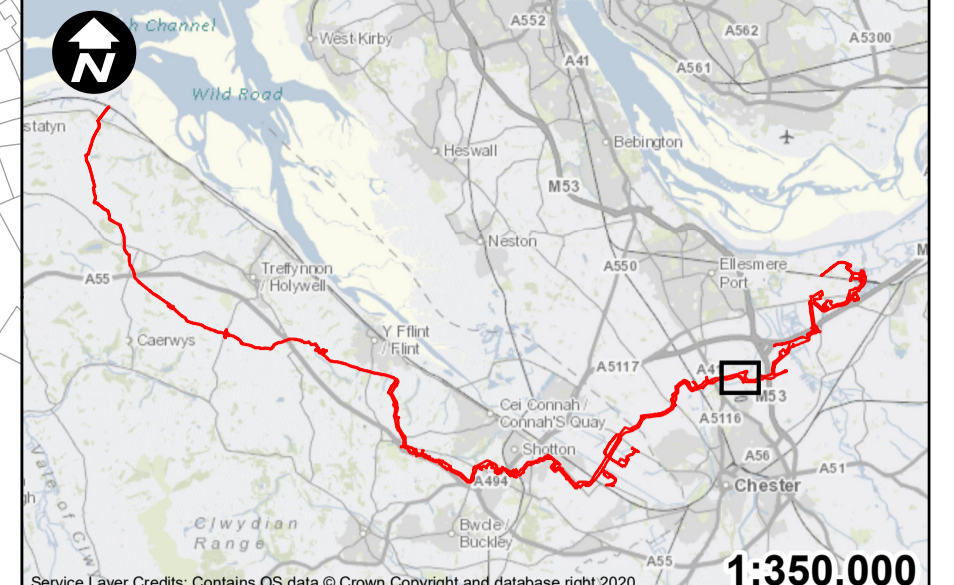
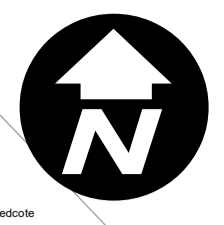

Service Layer Credits: Contains OS data © Crown Copyright and database right 2020

1:350,000

**Key:**

- Order Limits
- Permanent acquisition of subsurface
- Temporary possession of land
- Crown Land

1. All dimensions are in metres unless stated otherwise.
2. These Land Plans should be read in conjunction with other plans and documents in the Development Consent Order application in particular the Book of Reference.
3. All easements, servitudes and private rights in land are proposed to be extinguished on land shown coloured pink on these land plans. All easements, servitudes and private rights in land are proposed to be extinguished, so far as their continued exercise would be inconsistent with the exercise of the rights or restrictions proposed to be acquired by the undertaker on land shown coloured blue on these land plans. All easements, servitudes and private rights are proposed to be suspended while the undertaker is in temporary possession of the land shown coloured green on these land plans.
4. The number labels relate to plot numbers. Please refer to the Book of Reference for more information about these plots, including the approximate area of each plot (in square metres). Plot numbers include a reference to the relevant sheet of the Land Plans. In this numbering convention, a plot number comprises the sheet number followed by the actual plot number. e.g. Plot 01-24, where '01' is the sheet number (sheet 1) and '24' is the plot number (24 on sheet 1).

D	NC	PT	VB	18/05/2023
C	RH	PT	VB	28/02/2023
B	NC	RB	VB	13/01/2023
A	PM	JH	VB	27/09/2022
<b>REVISION</b>	<b>DRAWN</b>	<b>CHECKED</b>	<b>APPROVED</b>	<b>DATE</b>

**SCALE: 1:2,500**

Mapping reproduced by permission of Ordnance Survey on behalf of HMSO  
 Contains OS data © Crown Copyright and database right 2022

## HyNet North West

**PROJECT TITLE**  
 HyNet Carbon Dioxide Pipeline DCO

**DRAWING TITLE**  
 CROWN LAND PLANS REGULATION (5)(2)(n) APPLICATION DOCUMENT REFERENCE D.2.3 SHEET 8

<b>DRAWING STATUS</b>			
DEADLINE 3			
<b>DRAWN</b>	<b>CHECKED</b>	<b>APPROVED</b>	<b>AUTHORISED</b>
NC	PT	VB	AV
<b>SCALE @ A1 SIZE</b>		<b>DATE</b>	<b>REVISION</b>
1:2,500		18/05/2023	D

**DRAWING NUMBER**  
 EN070007-D.2.3-CLP-Sheet 8

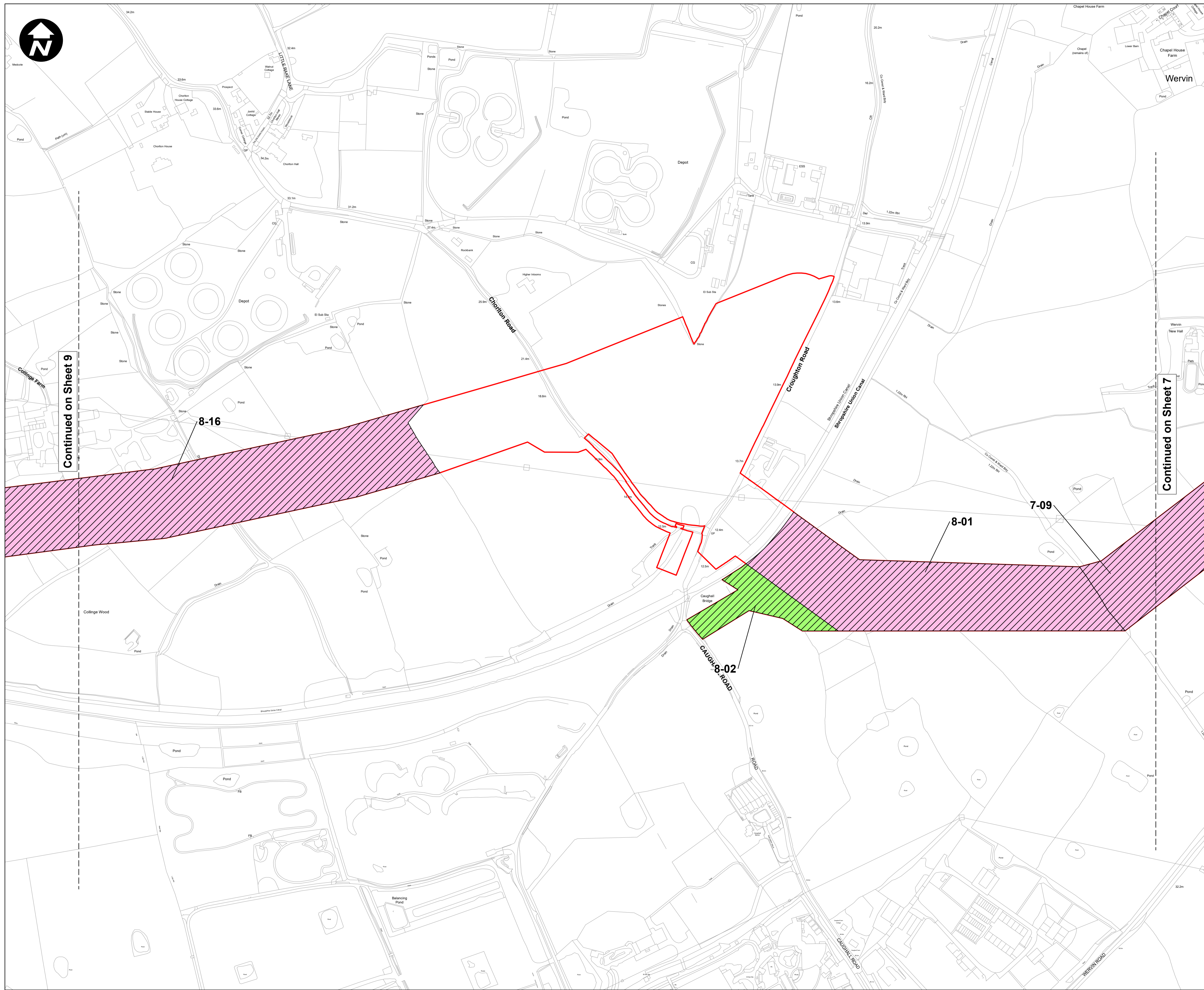

Continued on Sheet 9

Continued on Sheet 7

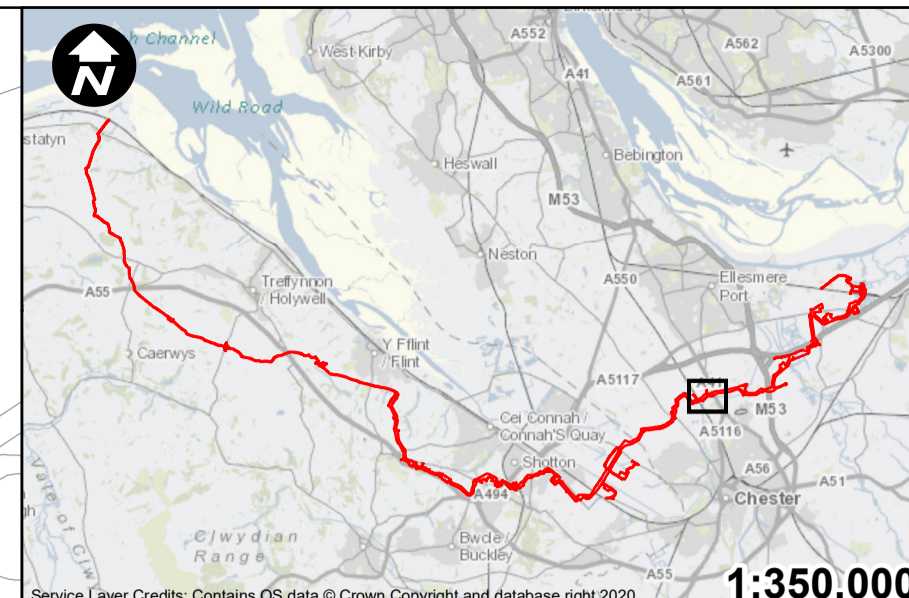

Service Layer Credits: Contains OS data © Crown Copyright and database right 2020 **1:350,000**

- Key:**
- Order Limits
  - Permanent acquisition of subsurface
  - Crown Land

1. All dimensions are in metres unless stated otherwise.
2. These Land Plans should be read in conjunction with other plans and documents in the Development Consent Order application in particular the Book of Reference.
3. All easements, servitudes and private rights in land are proposed to be extinguished on land shown coloured pink on these land plans. All easements, servitudes and private rights in land are proposed to be extinguished, so far as their continued exercise would be inconsistent with the exercise of the rights or restrictions proposed to be acquired by the undertaker on land shown coloured blue on these land plans. All easements, servitudes and private rights are proposed to be suspended while the undertaker is in temporary possession of the land shown coloured green on these land plans.
4. The number labels relate to plot numbers. Please refer to the Book of Reference for more information about these plots, including the approximate area of each plot (in square metres). Plot numbers include a reference to the relevant sheet of the Land Plans. In this numbering convention, a plot number comprises the sheet number followed by the actual plot number, e.g. Plot 01-24, where '01' is the sheet number (sheet 1) and '24' is the plot number (24 on sheet 1).

D	NC	PT	VB	18/05/2023
C	RH	PT	VB	28/02/2023
B	NC	RB	VB	13/01/2023
A	PM	JH	VB	27/09/2022
REVISION	DRAWN	CHECKED	APPROVED	DATE

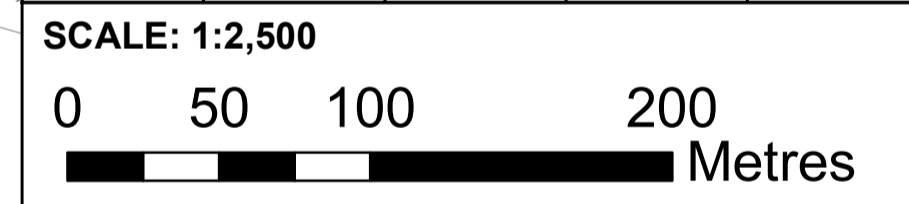

Mapping reproduced by permission of Ordnance Survey on behalf of HMSO  
 Contains OS data © Crown Copyright and database right 2022

## HyNet North West

**PROJECT TITLE**  
**HyNet Carbon Dioxide Pipeline DCO**

**DRAWING TITLE**  
 CROWN LAND PLANS REGULATION (5)(2)(n)  
 APPLICATION DOCUMENT REFERENCE D.2.3  
 SHEET 9

**DRAWING STATUS**  
**DEADLINE 3**

<b>DRAWN</b>	<b>CHECKED</b>	<b>APPROVED</b>	<b>AUTHORISED</b>
NC	PT	VB	AV
<b>SCALE @ A1 SIZE</b>		<b>DATE</b>	<b>REVISION</b>
1:2,500		18/05/2023	D

**DRAWING NUMBER**  
 EN070007-D.2.3-CLP-Sheet 9

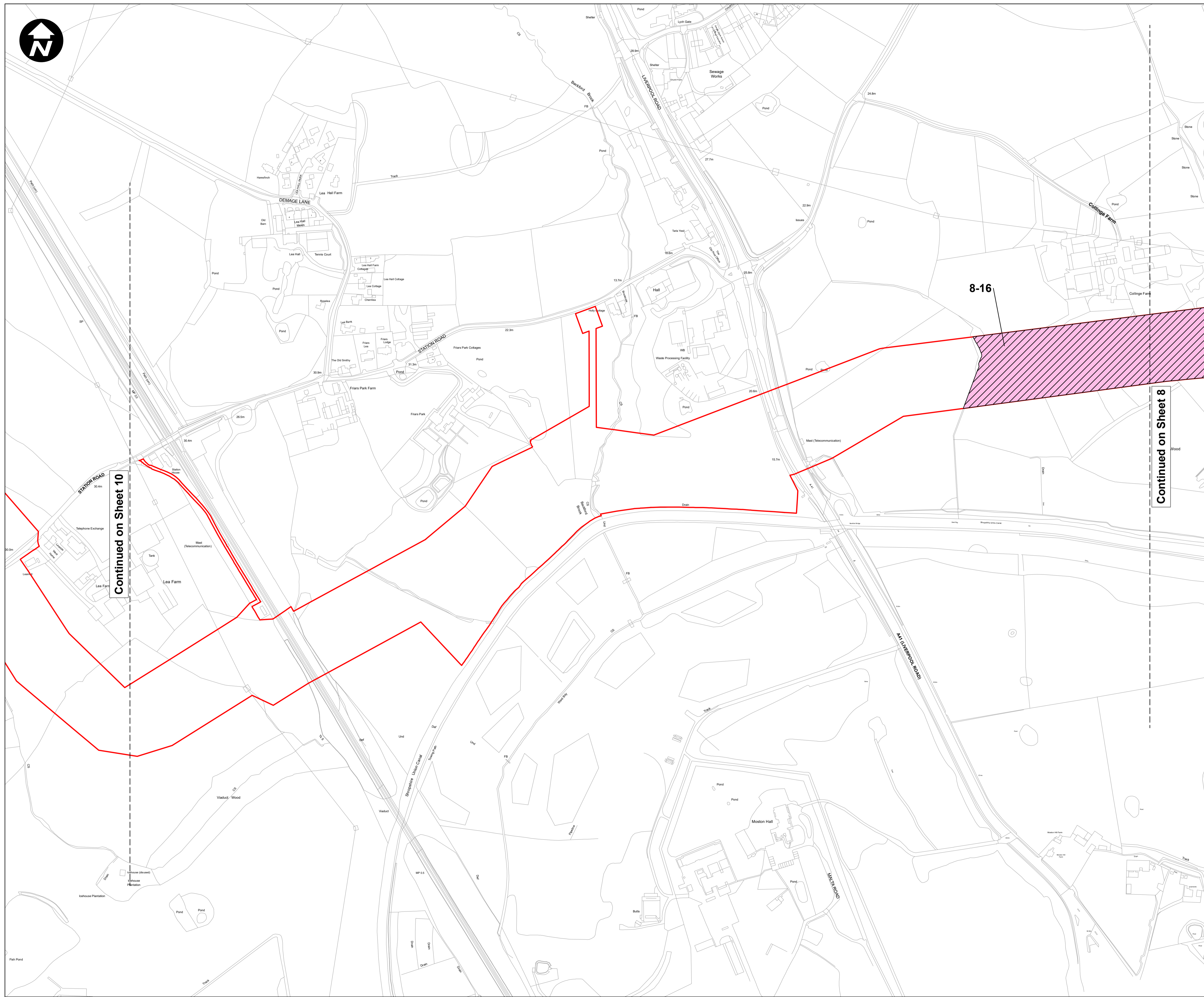

Continued on Sheet 10

Continued on Sheet 8



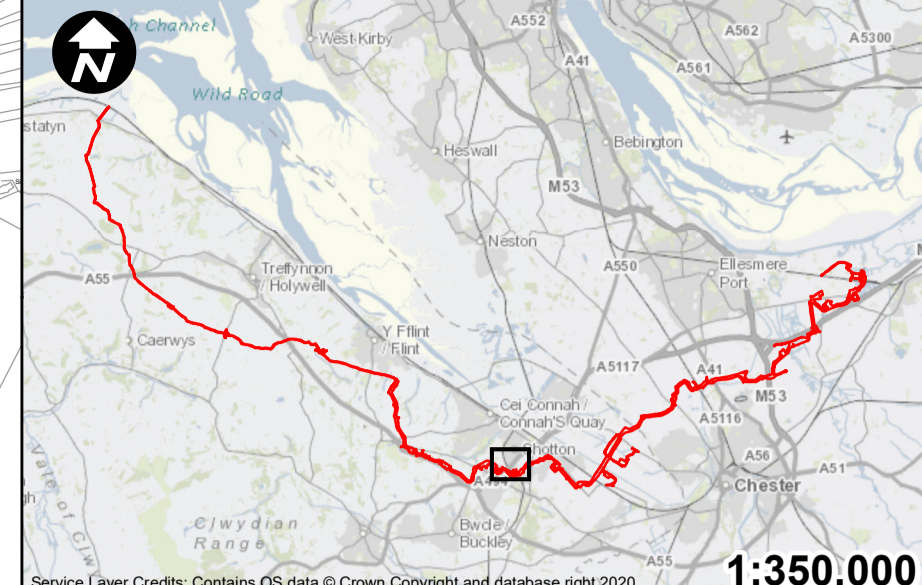
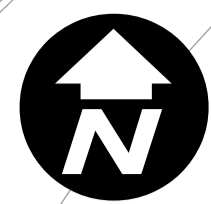

Service Layer Credits: Contains OS data © Crown Copyright and database right 2020

1:350,000

**Key:**

- Order Limits
- Permanent acquisition of subsurface
- Crown Land

1. All dimensions are in metres unless stated otherwise.
2. These Land Plans should be read in conjunction with other plans and documents in the Development Consent Order application in particular the Book of Reference.
3. All easements, servitudes and private rights in land are proposed to be extinguished on land shown coloured pink on these land plans. All easements, servitudes and private rights in land are proposed to be extinguished, so far as their continued exercise would be inconsistent with the exercise of the rights or restrictions proposed to be acquired by the undertaker on land shown coloured blue on these land plans. All easements, servitudes and private rights are proposed to be suspended while the undertaker is in temporary possession of the land shown coloured green on these land plans.
4. The number labels relate to plot numbers. Please refer to the Book of Reference for more information about these plots, including the approximate area of each plot (in square metres). Plot numbers include a reference to the relevant sheet of the Land Plans. In this numbering convention, a plot number comprises the sheet number followed by the actual plot number, e.g. Plot 01-24, where '01' is the sheet number (sheet 1) and '24' is the plot number (24 on sheet 1).

D	NC	PT	VB	18/05/2023
C	RH	PT	VB	28/02/2023
B	NC	RB	VB	13/01/2023
A	PM	JH	VB	27/09/2022
REVISION	DRAWN	CHECKED	APPROVED	DATE

SCALE: 1:2,500

0 50 100 200 Metres

Mapping reproduced by permission of Ordnance Survey on behalf of HMSO  
 Contains OS data © Crown Copyright and database right 2022

# HyNet North West

**PROJECT TITLE**  
**HyNet Carbon Dioxide Pipeline DCO**

**DRAWING TITLE**  
 CROWN LAND PLANS REGULATION (5)(2)(n)  
 APPLICATION DOCUMENT REFERENCE D.2.3  
 SHEET 17

**DRAWING STATUS**  
 DEADLINE 3

<b>DRAWN</b>	<b>CHECKED</b>	<b>APPROVED</b>	<b>AUTHORISED</b>
NC	PT	VB	AV
<b>SCALE @ A1 SIZE</b>		<b>DATE</b>	<b>REVISION</b>
1:2,500		18/05/2023	D

**DRAWING NUMBER**  
 EN070007-D.2.3-CLP-Sheet 17

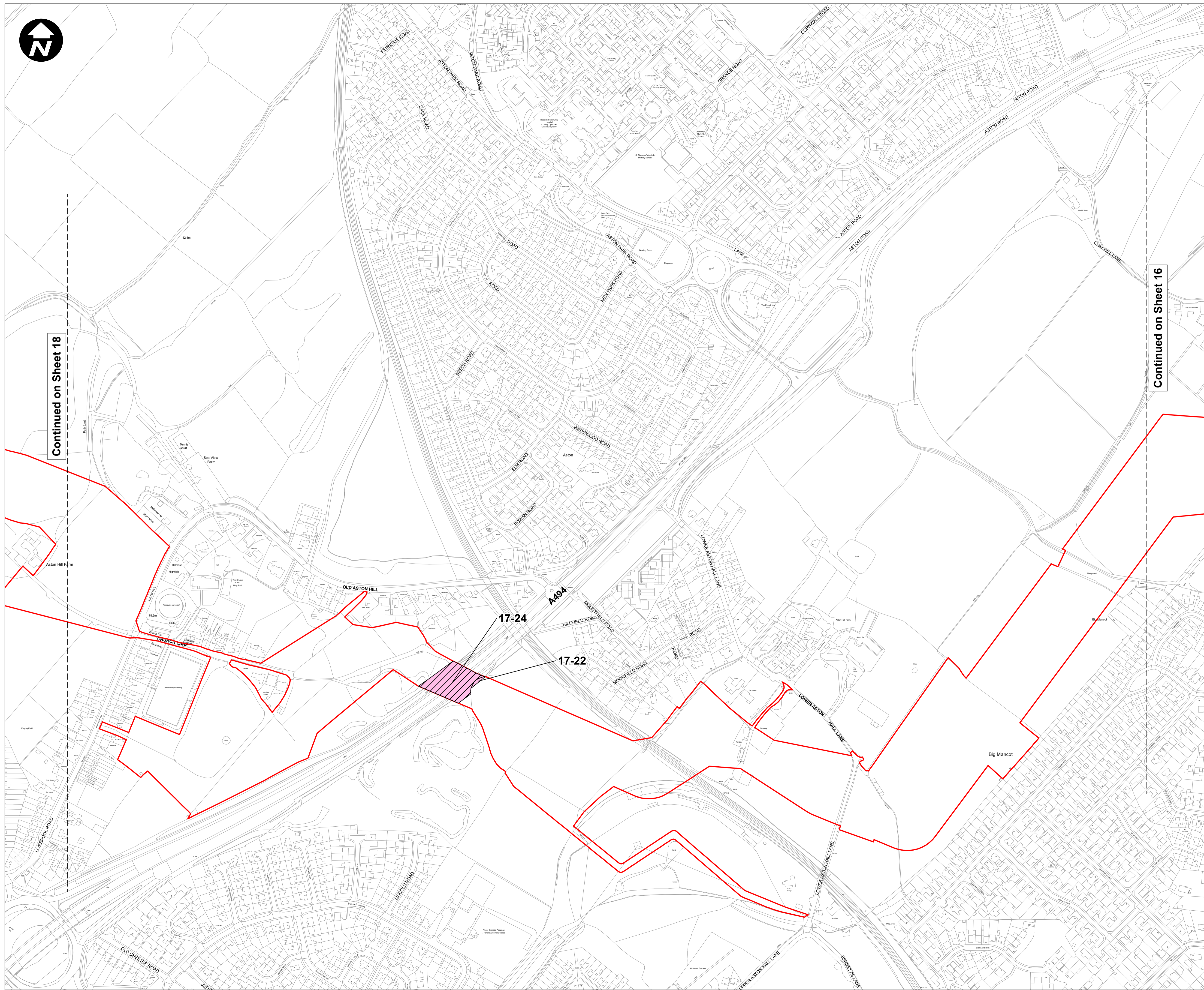

Continued on Sheet 18

Continued on Sheet 16

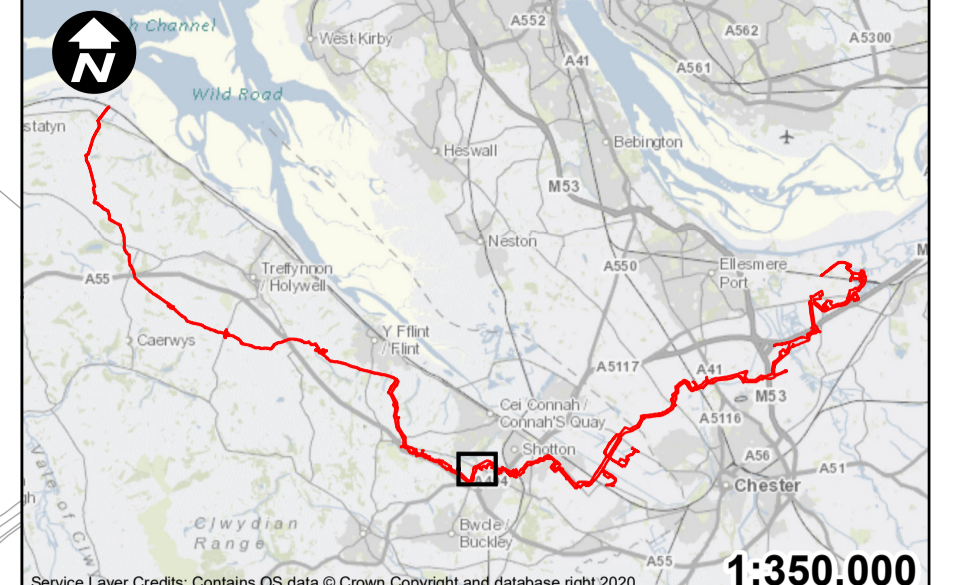

Service Layer Credits: Contains OS data © Crown Copyright and database right 2020

1:350,000

**Key:**

- Order Limits
- Permanent acquisition of subsurface
- Crown Land

1. All dimensions are in metres unless stated otherwise.
2. These Land Plans should be read in conjunction with other plans and documents in the Development Consent Order application in particular the Book of Reference.
3. All easements, servitudes and private rights in land are proposed to be extinguished on land shown coloured pink on these land plans. All easements, servitudes and private rights in land are proposed to be extinguished, so far as their continued exercise would be inconsistent with the exercise of the rights or restrictions proposed to be acquired by the undertaker on land shown coloured blue on these land plans. All easements, servitudes and private rights are proposed to be suspended while the undertaker is in temporary possession of the land shown coloured green on these land plans.
4. The number labels relate to plot numbers. Please refer to the Book of Reference for more information about these plots, including the approximate area of each plot (in square metres). Plot numbers include a reference to the relevant sheet of the Land Plans. In this numbering convention, a plot number comprises the sheet number followed by the actual plot number, e.g. Plot 01-24, where '01' is the sheet number (sheet 1) and '24' is the plot number (24 on sheet 1).

D	NC	PT	VB	18/05/2023
C	RH	PT	VB	28/02/2023
B	NC	RB	VB	13/01/2023
A	PM	JH	VB	27/09/2022
REVISION	DRAWN	CHECKED	APPROVED	DATE

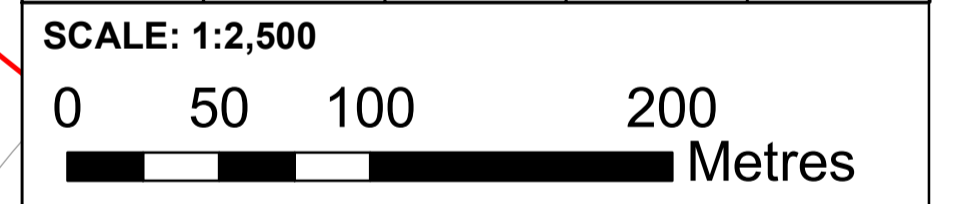

Mapping reproduced by permission of Ordnance Survey on behalf of HMSO  
 Contains OS data © Crown Copyright and database right 2022

# HyNet North West

**PROJECT TITLE**  
**HyNet Carbon Dioxide Pipeline DCO**

**DRAWING TITLE**  
 CROWN LAND PLANS REGULATION (5)(2)(n)  
 APPLICATION DOCUMENT REFERENCE D.2.3  
 SHEET 18

**DRAWING STATUS**  
**DEADLINE 3**

DRAWN	CHECKED	APPROVED	AUTHORISED
NC	PT	VB	AV

SCALE @ A1 SIZE	DATE	REVISION
1:2,500	18/05/2023	D

**DRAWING NUMBER**  
 EN070007-D.2.3-CLP-Sheet 18

Continued on Sheet 19

Continued on Sheet 17

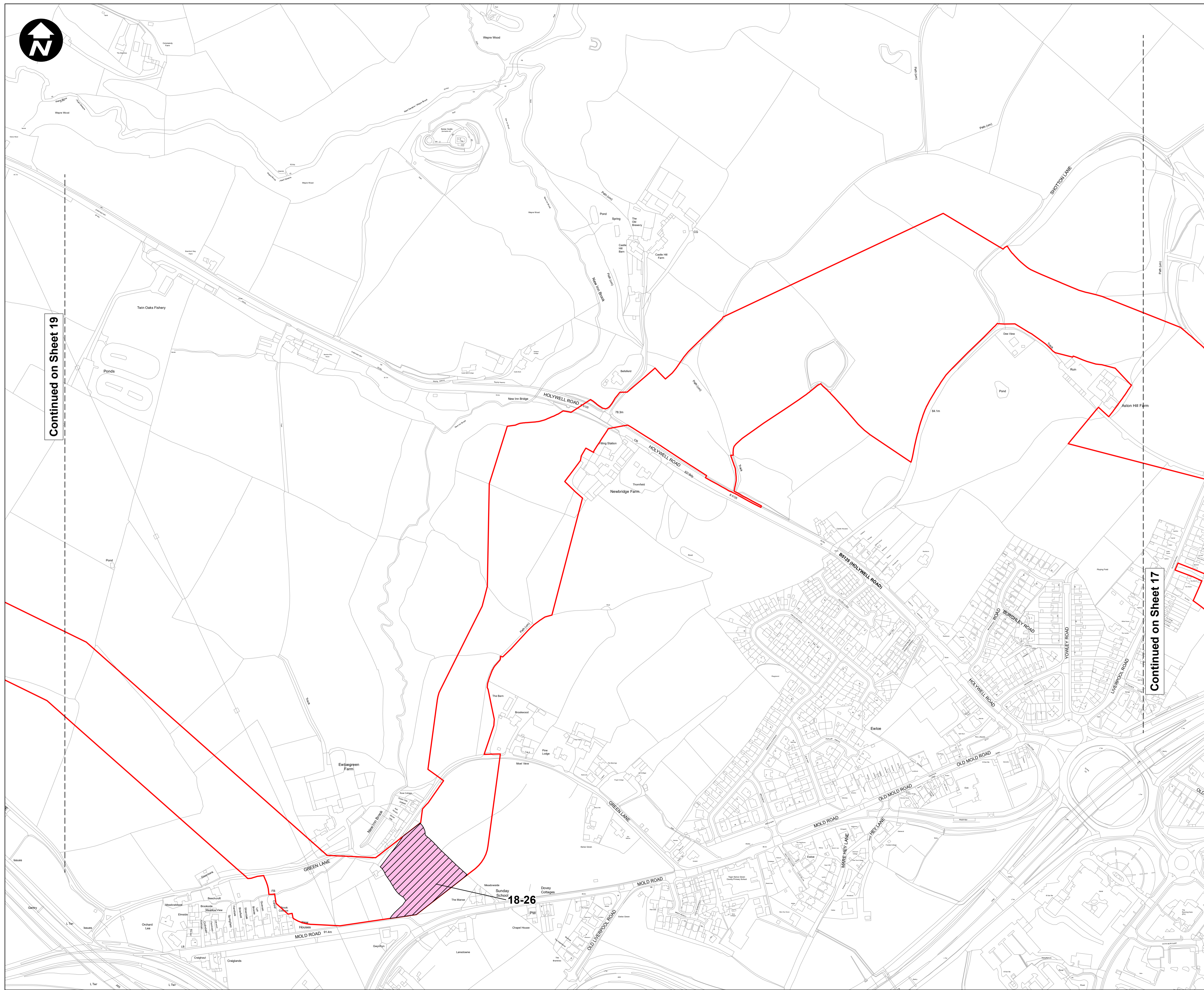

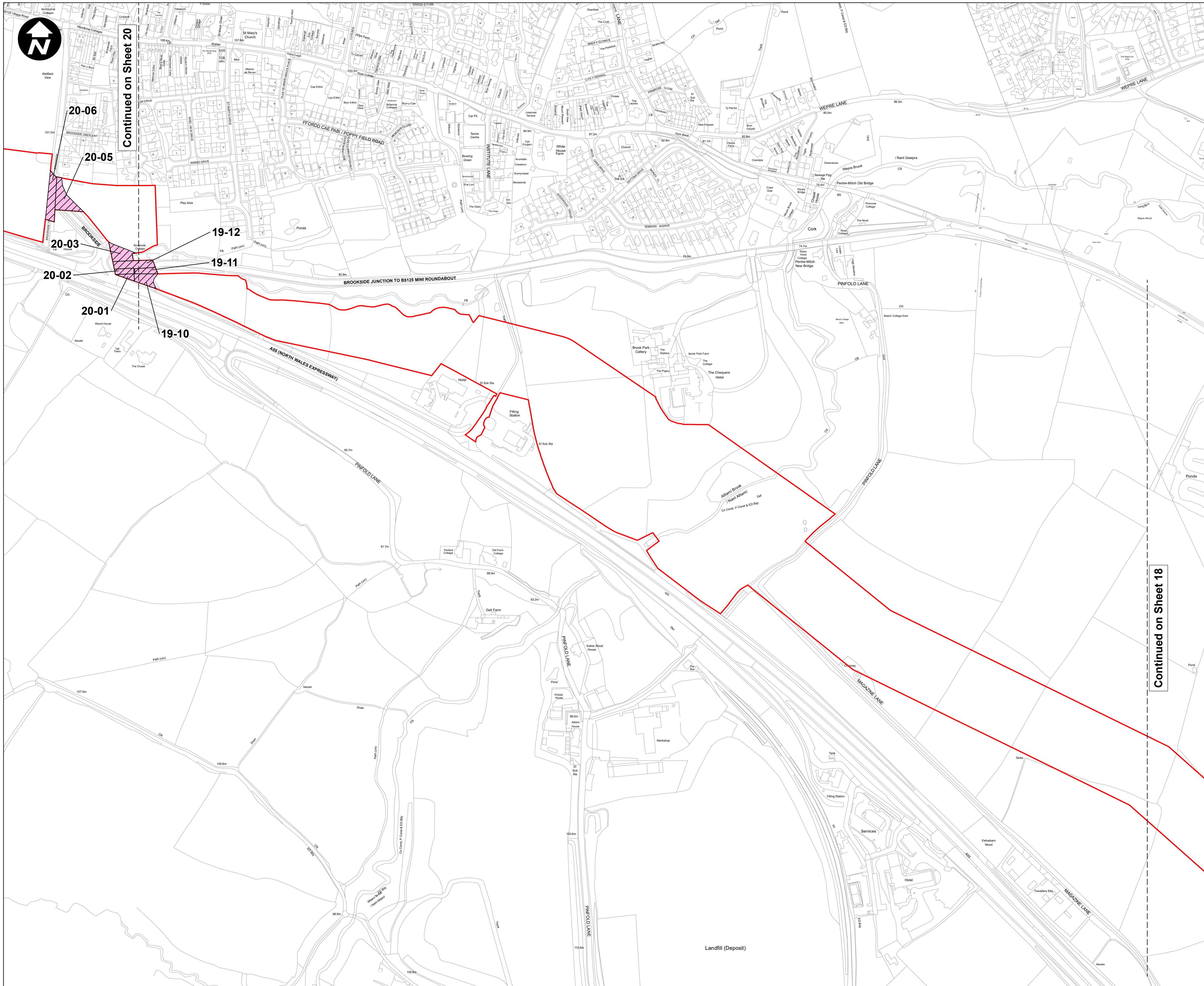

- Key:**
- Order Limits
  - Permanent acquisition of subsurface
  - Crown Land

1. All dimensions are in metres unless stated otherwise.
2. These Land Plans should be read in conjunction with other plans and documents in the Development Consent Order application in particular the Book of Reference.
3. All easements, servitudes and private rights in land are proposed to be extinguished on land shown coloured pink in these land plans. All easements, servitudes and private rights in land are proposed to be extinguished, so far as their continued exercise would be inconsistent with the exercise of the rights or restrictions proposed to be acquired by the undertaker on land shown coloured blue on these land plans. All easements, servitudes and private rights are proposed to be suspended while the undertaker is in temporary possession of the land shown coloured green on these land plans.
4. The number labels relate to plot numbers. Please refer to the Book of Reference for more information about these plots, including the approximate area of each plot (in square metres). Plot numbers include a reference to the relevant sheet of the Land Plans. In this numbering convention, a plot number comprises the sheet number followed by the actual plot number. e.g. Plot 01-24, where '01' is the sheet number (sheet 1) and '24' is the plot number (24 on sheet 1).

D	NC	PT	VB	18/05/2023
C	RH	PT	VB	28/02/2023
B	NC	RB	VB	13/01/2023
A	PM	JH	VB	27/09/2022
REVISION	DRAWN	CHECKED	APPROVED	DATE

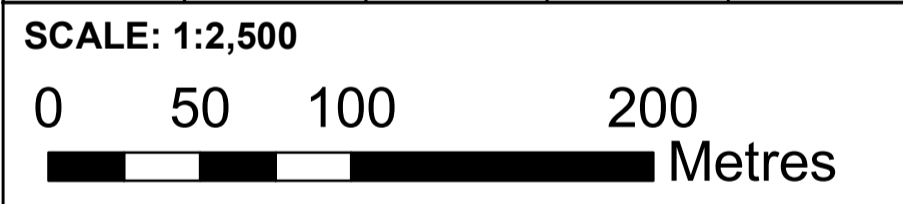

Mapping reproduced by permission of Ordnance Survey on behalf of HMSO  
 Contains OS data © Crown Copyright and database right 2022

# HyNet North West

## PROJECT TITLE HyNet Carbon Dioxide Pipeline DCO

**DRAWING TITLE**  
 CROWN LAND PLANS REGULATION (5)(2)(n)  
 APPLICATION DOCUMENT REFERENCE D.2.3  
 SHEET 19

**DRAWING STATUS**  
 DEADLINE 3

<b>DRAWN</b>	<b>CHECKED</b>	<b>APPROVED</b>	<b>AUTHORISED</b>
NC	PT	VB	AV
<b>SCALE @ A1 SIZE</b>		<b>DATE</b>	<b>REVISION</b>
1:2,500		18/05/2023	D

**DRAWING NUMBER**  
 EN070007-D.2.3-CLP-Sheet 19

Continued on Sheet 20

Continued on Sheet 18

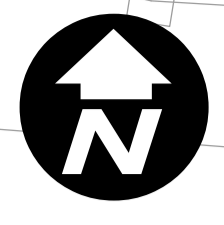

Continued on Sheet 23

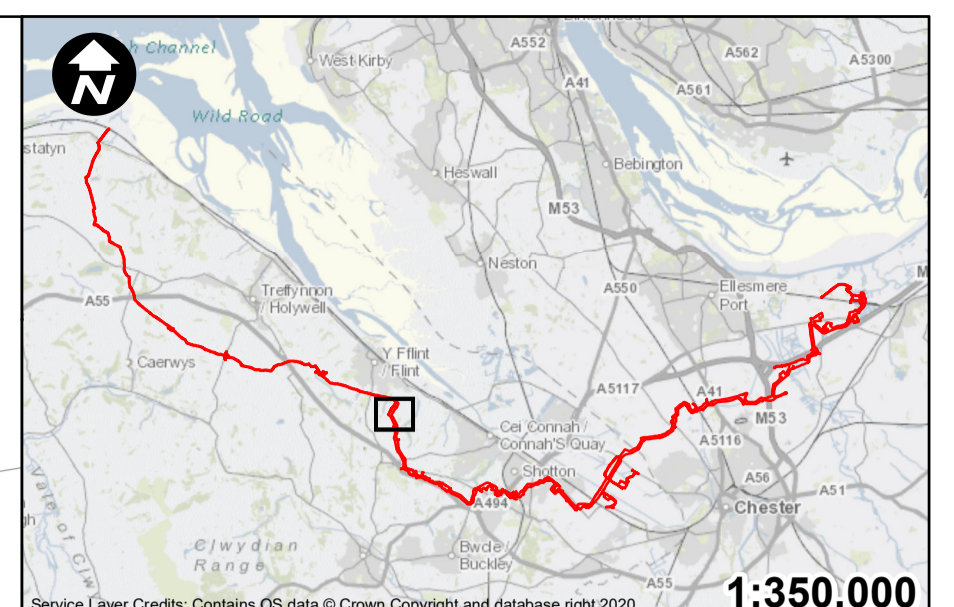

Service Layer Credits: Contains OS data © Crown Copyright and database right 2020 1:350,000

**Key:**

- Order Limits
- Permanent acquisition of land
- Permanent acquisition of subsurface
- Temporary possession of land
- Crown Land

1. All dimensions are in metres unless stated otherwise.
2. These Land Plans should be read in conjunction with other plans and documents in the Development Consent Order application in particular the Book of Reference.
3. All easements, servitudes and private rights in land are proposed to be extinguished on land shown coloured pink on these land plans. All easements, servitudes and private rights in land are proposed to be extinguished, so far as their continued exercise would be inconsistent with the exercise of the rights or restrictions proposed to be acquired by the undertaker on land shown coloured blue on these land plans. All easements, servitudes and private rights are proposed to be suspended while the undertaker is in temporary possession of the land shown coloured green on these land plans.
4. The number labels relate to plot numbers. Please refer to the Book of Reference for more information about these plots, including the approximate area of each plot (in square metres). Plot numbers include a reference to the relevant sheet of the Land Plans. In this numbering convention, a plot number comprises the sheet number followed by the actual plot number, e.g. Plot 01-24, where '01' is the sheet number (sheet 1) and '24' is the plot number (24 on sheet 1).

D	NC	PT	VB	18/05/2023
C	RH	PT	VB	28/02/2023
B	NC	RB	VB	13/01/2023
A	PM	JH	VB	27/09/2022
REVISION	DRAWN	CHECKED	APPROVED	DATE

**SCALE: 1:2,500**

Mapping reproduced by permission of Ordnance Survey on behalf of HMSO  
 Contains OS data © Crown Copyright and database right 2022

# HyNet North West

**PROJECT TITLE**  
**HyNet Carbon Dioxide Pipeline DCO**

**DRAWING TITLE**  
 CROWN LAND PLANS REGULATION (5)(2)(n)  
 APPLICATION DOCUMENT REFERENCE D.2.3  
 SHEET 22

**DRAWING STATUS**  
**DEADLINE 3**

DRAWN	CHECKED	APPROVED	AUTHORISED
NC	PT	VB	AV
<b>SCALE @ A1 SIZE</b>		<b>DATE</b>	<b>REVISION</b>
1:2,500		18/05/2023	D
<b>DRAWING NUMBER</b>			
EN070007-D.2.3-CLP-Sheet 22			

Continued on Sheet 21

